

LED

LED FIXTURE



- No cable necessary for the network control or according to the application location, mixed with wired and wireless network.
- High speed dynamic PWM colour LED controlling function.
- The controlling function can be programmed according to the customer's requirements.
- Mini Wet V fixture body, IP67 protection grade Aluminium Die casting housing 7 years guaranteed for the fixture body. Perfect for outdoor application.
- The revolutionary controlling system is more than ever the ideal gear for your dramatic lighting creation.
- Good for lighting of bars, restaurants, theatres; TV studios, architectural lighting and more.

No cable No Fuzz

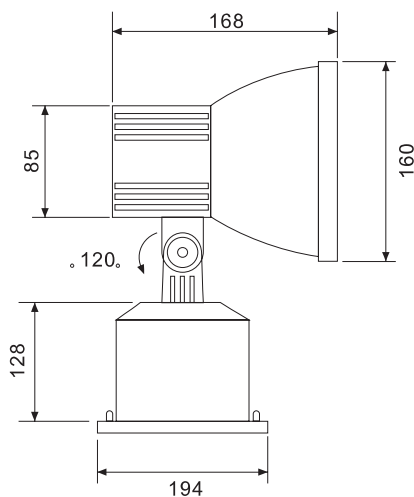

Technical Specification

- △ Light source: 1W super-luminance LED (LUMILEDS).
- △ 100,000 hrs life time.
- △ Colour effect: RGB color mixing continuously, timer-controlled colour changing, colour chasing and more.
- △ Beam angle: narrow, medium and wide beam available.
- △ Controlling method: cable network or wireless lan network.
- △ Communication protocol: RS-485 physical network structure, can be adapted to different kinds of communication protocols. DMX512 protocol can be applied for the cable network controlled.
- △ Power wattage: 10W/each light fixture
- △ LED working voltage: 12V-DC
- △ Input voltage: 110V/220V/230V-AC
- △ Ambient temperature: -20°C—70°C
- △ Weight: 3.6Kg.



Wireless Lan Controlled LED colour change spotlight A Ideal gear for your creative idea!

Smart outlook design with compact and firmness structure.
 Aluminium die-casting end cap and anodized extrusion housing.
 Special design of "clip on" system guarantee IP rated and easy maintenance.
 IP66 protection, with silicon gasket.
 Adjustable for outdoor and indoor lighting for architecture, bridge and wall washing. Etc.
 Color change, color emphasis...

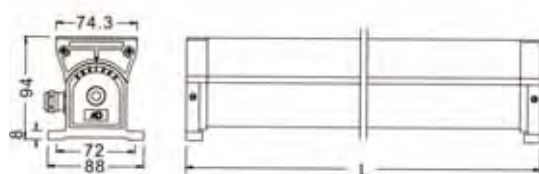

TUF-600LED-RGB18
 LED18W 615X88X96
 2.5 Kg.

TUF-1000LED-RGB27
 LED27W 615X88X96
 4 Kg.

TUF-600LED-W18
 LED WHITE 18W
 615X88X96
 2.5 Kg.

TUF-1000LED-W27
 LED WHITE 27W
 1000X88X96
 4 Kg.

TUF-600LED-R18
 LED RED 18W
 615X88X96
 2.5 Kg.

TUF-1000LED-R27
 LED RED 27W
 1000X88X96
 4 Kg.

TUF-600LED-G18
 LED GREEN 18W
 615X88X96
 2.5 Kg.

TUF-1000LED-G27
 LED GREEN 27W
 1000X88X96
 4 Kg.

TUF-600LED-B18
 LED BLUE 18W
 615X88X96
 2.5 Kg.

TUF-1000LED-B27
 LED BLUE 27W
 1000X88X96
 4 Kg.

Accurate casting angle adjusting and looking function, can adjust maximum 45° (both sides).

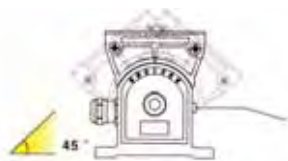

Special design of "clip on" system guarantee IP rated and easy maintenance.

Color: red, yellow, white. purple. orange. green. blue. diversified dynamic and static mix coloring program available.

Light source; 1W super-brightness LED.

Beam angle: from 10° to 45° angle filters available.

Controlling: cable network or wireless network, mixed cable and wireless network, supervision system available.

Capacity: 10000 network lamp knots.

Communication protocol: RS-485 physical network structure, adjustable to different remote comunicación.



The luminaire could be adjusted the lighting angle by using optional accesories for expecting effect.



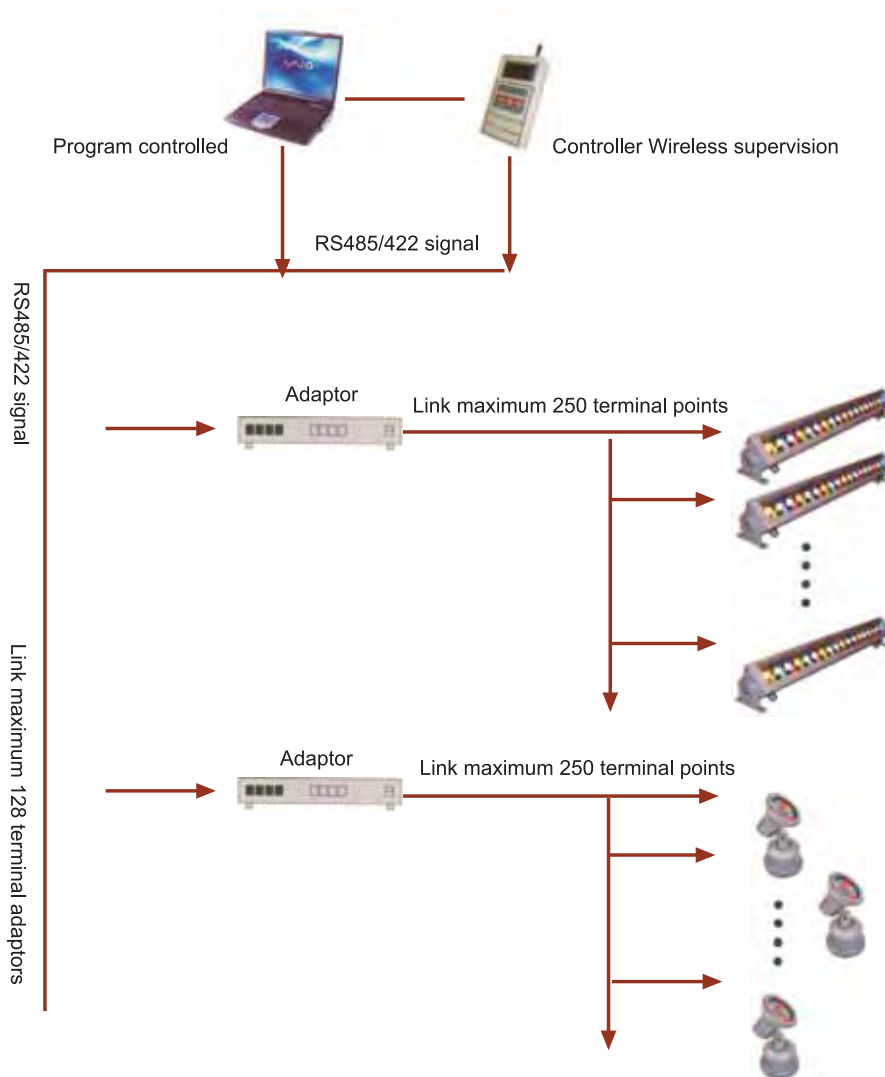

Multiple 3D physical network supervision system is adaptable to any different environment. It can be adjusted to sole cable network, sole wireless network or mixed cable and wireless pattern, according to the actual application.

Equipped with recessed mini power system SCM from ATMEL U.S., the LED controller possesses high-speed dynamic PWM color controlling ability. Integrated accurate coding technology, it is dramatically anti-puzzling and assures stable communication.

LED lamp uses no less than 1W products.

Die cast & extrusion aluminium housing, with anti-corrosion powder coating, it is compress designed and applicable for any indoor and outdoor colorfull LED lighting uses.

WET LINEAL LED

- Applicable for different lamp sources:
1W LED (Lumilde).
- Heavy duty die-cast and extrusion aluminium housing.
- BODYGUARD—7-YEAR FINISH WARRANTY
- Water-proof plug-in system for easy installation on site
- Applicable for: Facade, spot lighting, landscape, etc.
- High protection class: IP65

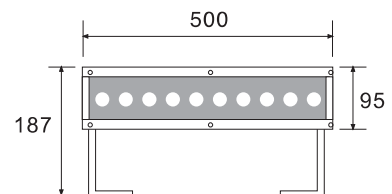
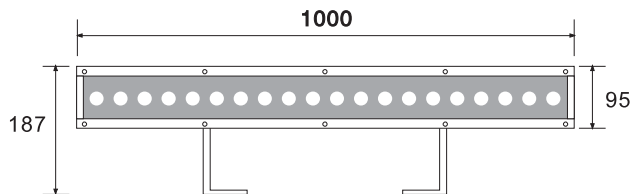

TUF-1000 LED

Technical Specification

DD1520 TUF-1000 LED

Light Source: 1W LED (LUMILDE)

100000 hrs time life

Colour: white

Power wattage: 20W

LED working Voltage: 12V-DC

Input Voltage: 110V/220V/230V-AC

Ambient temperature: -20°C~60°C

Beam angle: Narrow, Medium and Wide Beam

Light Fixture Length: 1000mm

Weight: 5.5kg

TUF-1000 LED

Technical Specification

DD1521 TUF-500 LED

Light Source: 1W LED (LUMILDE)

100000 hrs time life

Colour: white

Power wattage: 10W

LED working Voltage: 12V-DC

Input Voltage: 110V/220V/230V-AC

Ambient temperature: -20°C~60°C

Beam angle: Narrow, Medium and Wide Beam

Light Fixture Length: 500mm

Weight: 3.9kg

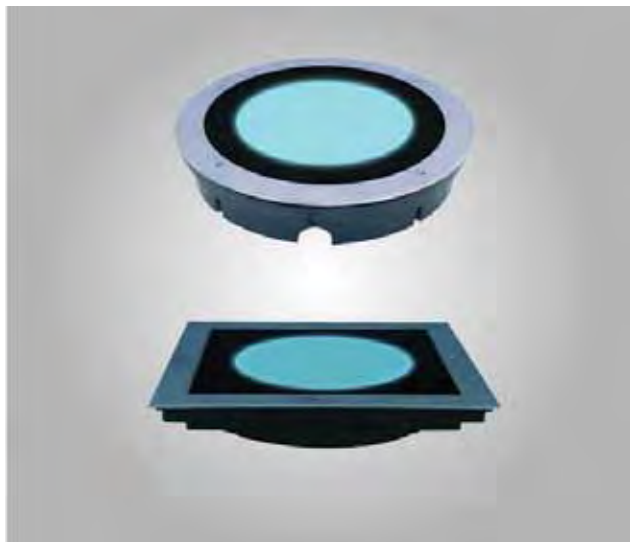

RS-485 physical network structure is adapted to this system design, which is suitable to many telecom arrangements, and DMX512 arrangement control system is available.

High speed dynamic PWM colour LED controlling function.

Enjoy various diversified color and in-phase.

Super-thin housing with 5 cm thickness. Buried or wall-recessed mounted.

Body is made of die-cast aluminium. With stainless steel plate. Suit for the decoration of interior and exterior.

The LED fixture is widely used for the decoration of interior and exterior.

IP67. Resisting 3 tons pressure.

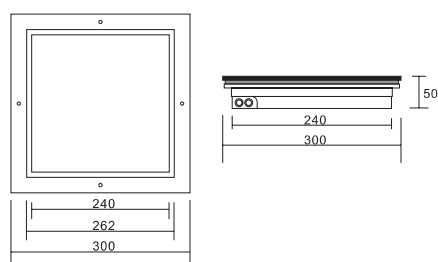
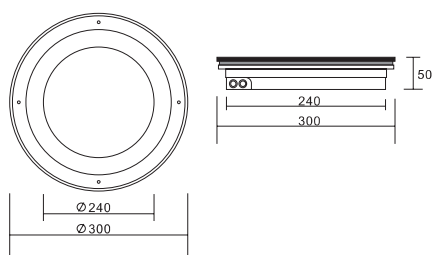

Technical Specification

Light Source: 72 super-luminance LEDs (LUMILEDS).

100,000 hrs time life

Colour effect: RGB color mixing continuously, timer-controlled colour changing, colour chasing and more.

Beam angle: 120°

Communication protocol: RS-485 physical network structure, can be adapted to different kinds of communication protocols. DMX512 protocol can be applied for the cable network controlled.

Power wattage: 5W

LED working voltage: 110V/220V/230V-AC

Input voltage: -20°C--70°C

Beam angle: Narrow, Medium and Wide Beam

Light Fixture Length: 500mm

Weight: 3.9kg



ADMWQ-2001
220V/12V



ADMWQ-0002
220V/12V

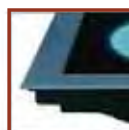

ADMWQ-2002
220V/12V



ADMWQ-3001
220V/12V



ADMWQ-1002
220V/12V

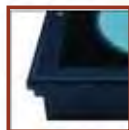

ADMWQ-3002
220V/12V

Power supply: AC 95-260V/50-60HZ

Power Output: DC 12V

Lamp: white

Life expectancy:>100,000 hrs.

Colour Temperature: 6000-9000K

Wattage: 1W-8W

Brightness:>200cd/m2

Transformer: Integrated inside the housing or max 15 pcs fixtures controlled by a remote DC converter. IP67. Resisting 3 tons pressure.



Different Signs on the fixture is possible

Customer can choose from the following signcode or tailor-made sign.

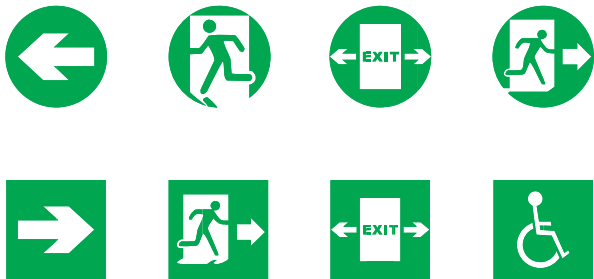

ADMWQ-4001
220V/12V



ADMWQ-5001
220V/12V



ADMWQ-4002
220V/12V



ADMWQ-5002
220V/12V

Good for emergency lighting and orientation lighting for commercial area, airport, railway station, administration and office building, hotels, corridors and exhibitions centres, and can also be installed outdoors, such as outdoor plaza, pathway and channels, etc.



PRaha
lighting

825 Union Pacific St.
Laredo, Texas 78045
East Point Industrial Park

www.prahalighting.com